

**vtech**<sup>®</sup>

User's Manual

**Go! Go! Smart Animals**<sup>®</sup>  
*Playtime goes wild with learning!*<sup>™</sup>

**Doggie Playhouse**<sup>™</sup>



© 2016 VTech  
Printed in China  
91-003149-000<sup>US</sup>

*Dear Parent,*

*Welcome to the world of **Go! Go! Smart Animals**®! We're excited you've decided to go on an adventure with us and explore all that **Go! Go! Smart Animals**® has to offer. These toys have been designed to give your child a thrilling learning experience with hours of fun.*

***Go! Go! Smart Animals**® features a collection of animals that interact with your child by lighting up and playing music and sounds while teaching your child letters and animal names\*. But that's only the beginning of the learning excitement! When your child interacts with our innovative **SmartPoint**® technology, they will love hearing the animals respond to each **SmartPoint**® location on **Go! Go! Smart Animals**® and **Go! Go! Smart Wheels**® playsets\* with different phrases, cheerful melodies, sing-along songs or sound effects.*

*Additionally, our **Go! Go! Smart Animals**® playsets can be connected to other playsets including **Go! Go! Smart Wheels**® to stimulate your child's creativity. The playsets also feature buttons, gears and other manipulative elements to encourage the development of your child's fine motor skills.*

*With **Go! Go! Smart Animals**®, playtime goes wild with learning!*

*Sincerely,*

*Your friends at **VTech**®*

*To learn more about **VTech**® toys, visit [vtechkids.com](http://vtechkids.com)*

\*Each sold separately.

# INTRODUCTION

Thank you for purchasing the **VTech® Go! Go! Smart Animals® Doggie Playhouse™** playset!

Have a howling good time at the **Go! Go! Smart Animals® Doggie Playhouse™**. Learn about animals and more with the **SmartPoint®** dog. Explore the dog house, ride on the swing and search for buried treasure!

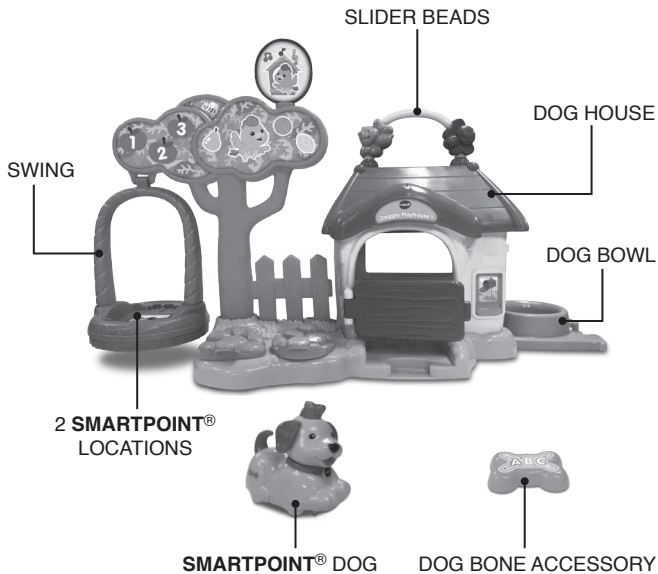

# INCLUDED IN THIS PACKAGE



One **SmartPoint**® Dog



One tree with fence



One **SmartPoint**® swing base



One swing bracket



One **SmartPoint**® base



One front wall



One back wall



One roof



One slider with beads



One dog bone accessory

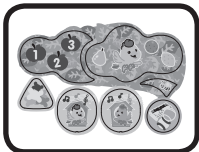

One label sheet

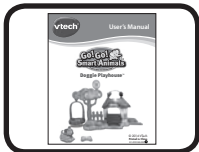

One user's manual

INCLUDED IN THIS PACKAGE

**WARNING:** All packing materials, such as tape, plastic sheets, packaging locks and tags are not part of this toy, and should be discarded for your child's safety.

**ATTENTION:** Pour la sécurité de votre enfant, débarrassez-vous de tous les produits d'emballage tels que rubans adhésifs, feuilles de plastique, attaches et étiquettes. Ils ne font pas partie du jouet.

**NOTE:** Please keep this user's manual as it contains important information.

## Unlock the packaging locks:

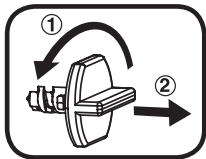

- ① Turn the packaging lock counter-clockwise several times.
- ② Pull out and discard the packaging lock.

# GETTING STARTED

## BATTERY INSTALLATION – DOG

1. Make sure the unit is turned **OFF**.
2. Locate the battery cover on the bottom of the dog. Use a coin or a screwdriver to loosen the screw.
3. Install 2 new “AAA” (AM-4/LR03) batteries following the diagram inside the battery box. (The use of new alkaline batteries is recommended for maximum performance.)
4. Replace the battery cover and tighten the screw to secure the battery cover.

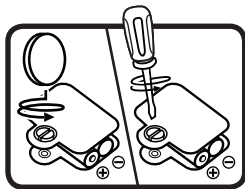

## BATTERY NOTICE

- Use new alkaline batteries for maximum performance.
- Use only batteries of the same or equivalent type as recommended.
- Do not mix different types of batteries: alkaline, standard (carbon-zinc) or rechargeable (Ni-Cd, Ni-MH), or new and used batteries.
- Do not use damaged batteries.
- Insert batteries with the correct polarity.
- Do not short-circuit the battery terminals.
- Remove exhausted batteries from the toy.
- Remove batteries during long periods of non-use.
- Do not dispose of batteries in fire.
- Do not charge non-rechargeable batteries.
- Remove rechargeable batteries from the toy before charging (if removable).
- Rechargeable batteries are only to be charged under adult supervision.

Please adhere the labels to the playset securely as indicated below:

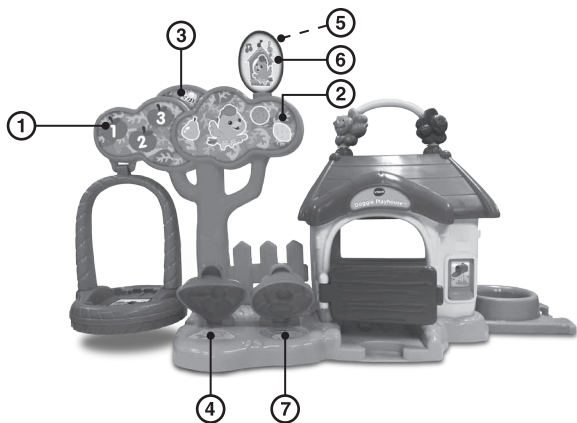
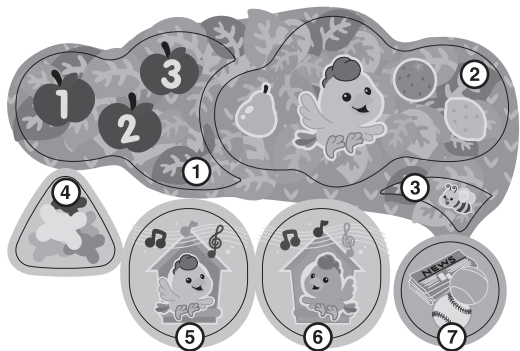

# ASSEMBLY INSTRUCTIONS

With the VTech® Go! Go! Smart Animals® Doggie Playhouse™, safety comes first. To ensure your child's safety, adult assembly is required.

1. Attach the **FRONT WALL** to the **SmartPoint® BASE**. Then, attach the **BACK WALL** to the **SmartPoint® BASE** as shown. You will hear a “click” sound to indicate each wall is secured to the **SmartPoint® BASE**. Once the walls are connected, they cannot be detached.

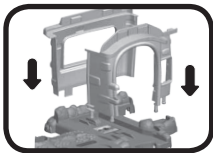

2. Attach the **ROOF** to the top of the dog house as shown. You will hear a “click” sound to indicate the **ROOF** is secure. Once the **ROOF** is connected, it cannot be detached.

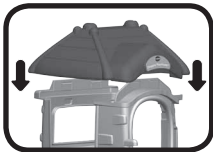

3. Insert the **SLIDER WITH BEADS** into the **ROOF**. You will hear a “click” sound to indicate the **SLIDER WITH BEADS** is secure. Once the **SLIDER WITH BEADS** is connected to the **ROOF**, it cannot be detached.

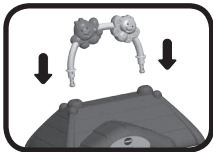

4. Insert the **TREE WITH FENCE** into the **SmartPoint® BASE** as shown. Once the **TREE WITH FENCE** is connected to the **SmartPoint® BASE**, it cannot be detached.





5. Insert the **SWING BRACKET** into the **SmartPoint® SWING BASE**. You will hear a “click” sound to indicate the **SWING BRACKET** and **SmartPoint® SWING BASE** are secure. Once the **SWING BRACKET** and **SmartPoint® SWING BASE** are connected, they cannot be detached.

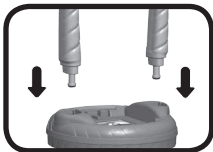

6. Attach the **SWING BRACKET** to the **TREE WITH FENCE** as shown. You will hear a “click” sound to indicate the swing is secure.

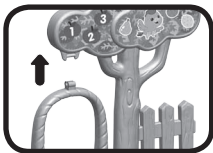

Once you've completed the above steps, you are ready to play! You can connect the **Doggie Playhouse™** to other **Go! Go! Smart Animals®** and **Go! Go! Smart Wheels®** playsets (each sold separately).

## EXPAND & EXPLORE

Connect to the **Go! Go! Smart Animals® Deluxe Track Set** or other **Go! Go! Smart Animals®** and **Go! Go! Smart Wheels®** playsets (each sold separately) to expand the **Doggie Playhouse™** and inspire creativity.

# PRODUCT FEATURES – DOG

## 1. ON/OFF SWITCH

To turn the unit **ON**, slide the **ON/OFF SWITCH** to the **ON** (⏻) position. To turn the unit **OFF**, slide the **ON/OFF SWITCH** to the **OFF** (●) position.

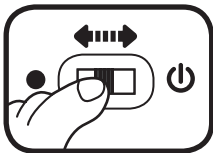

## 2. AUTOMATIC SHUT-OFF

To preserve battery life, the **VTech® Go! Go! Smart Animals®** dog will automatically power-down after approximately 60 seconds without input. The unit can be turned on again by pressing the light-up button, pushing the dog quickly, triggering a **SmartPoint®** location or turning the dog off and on.

**Note:** This product is in try-me mode in the packaging. After opening the package, turn the dog off and on again to proceed with normal play.

## ACTIVITIES – DOG

1. Slide the **ON/OFF SWITCH** to the **ON** (⏻) position to turn the unit **ON**. You will hear a dog sound, a song and a phrase. The light will flash with the sounds.
2. Press the **LIGHT-UP BUTTON** to hear fun sounds, sing-along songs and phrases. The light will flash with the sounds.

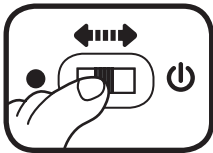

3. Push the dog to hear fun sounds and melodies. While a melody is playing, push the dog again to add fun sounds on top of the melody. The light will flash with the sounds.
4. For added fun, the dog interacts with all **VTech® Go! Go! Smart Animals®** playsets (each sold separately). Simply roll the dog over **SmartPoint®** locations to see the light flash and to hear greetings, fun sounds, short tunes and sing-along songs. You can also play with your animal on **Go! Go! Smart Wheels®** playsets (each sold separately).



## ACTIVITIES – DOGGIE PLAYHOUSE™

1. Move the dog or any **VTech® Go! Go! Smart Animals® SmartPoint®** animal (each sold separately) over one of the two **SmartPoint®** locations to trigger fun phrases, sounds and music.
2. Place the dog on the swing to trigger a fun response, and pretend to play on a tire swing.



3. Open and close the doggie door to let the dog in and out of the house. When the dog is placed in the house, the **SmartPoint**<sup>®</sup> will trigger a fun response.



4. Flip the dog bowl on the side of the house down when the dog is ready to eat. Flip it up when he is finished.



5. Lift the bushes and rock pile up and down to find what the dog has hidden around his house.



6. Move the sliding beads back and forth to pretend the butterfly and bee are flying around the house.

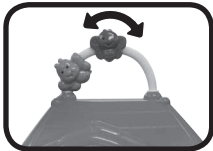

## CARE & MAINTENANCE

1. Keep the unit clean by wiping it with a slightly damp cloth.
2. Keep the unit out of direct sunlight and away from any direct heat source.
3. Remove the batteries when the unit will not be in use for an extended period of time.
4. Do not drop the unit on hard surfaces and do not expose the unit to moisture or water.

# TROUBLESHOOTING

If for some reason the program/activity stops working, please follow these steps:

1. Please turn the unit **OFF**.
2. Interrupt the power supply by removing the batteries.
3. Let the unit stand for a few minutes, then replace the batteries.
4. Turn the unit **ON**. The unit should now be ready to play again.
5. If the product still does not work, replace with an entire set of new batteries.

If the problem persists, please call our Consumer Services Department at 1-800-521-2010 in the U.S. or 1-877-352-8697 in Canada, and a service representative will be happy to help you.

For information on this product's warranty, please call **VTech**<sup>®</sup> at 1-800-521-2010 in the U.S. or 1-877-352-8697 in Canada.

## **IMPORTANT NOTE:**

Creating and developing **Infant Learning** products is accompanied by a responsibility that we at **VTech**<sup>®</sup> take very seriously. We make every effort to ensure the accuracy of the information, which forms the value of our products. However, errors sometimes can occur. It is important for you to know that we stand behind our products and encourage you to call our Consumer Services Department on at 1-800-521-2010 in the U.S. or 1-877-352-8697 in Canada, with any problems and/or suggestions that you might have. A service representative will be happy to help you.

## Note:

This equipment has been tested and found to comply with the limits for a Class B digital device, pursuant to Part 15 of the FCC Rules. These limits are designed to provide reasonable protection against harmful interference in a residential installation. This equipment generates, uses and can radiate radio frequency energy and, if not installed and used in accordance with the instructions, may cause harmful interference to radio communications. However, there is no guarantee that interference will not occur in a particular installation.

If this equipment does cause harmful interference to radio or television reception, which can be determined by turning the equipment off and on, the user is encouraged to try to correct the interference by one or more of the following measures:

- Reorient or relocate the receiving antenna.
- Increase the separation between the equipment and receiver.
- Connect the equipment into an outlet on a circuit different from that to which the receiver is connected.
- Consult the dealer or an experienced radio/TV technician for help.

**Caution:** Changes or modifications not expressly approved by the party responsible for compliance could void the user's authority to operate the equipment.

THIS DEVICE COMPLIES WITH PART 15 OF THE FCC RULES. OPERATION IS SUBJECT TO THE FOLLOWING TWO CONDITIONS: (1) THIS DEVICE MAY NOT CAUSE HARMFUL INTERFERENCE, AND (2) THIS DEVICE MUST ACCEPT ANY INTERFERENCE RECEIVED, INCLUDING INTERFERENCE THAT MAY CAUSE UNDESIRE OPERATION.

*CAN ICES-3 (B)/NMB-3(B)*



## PRODUCT WARRANTY

This Warranty is applicable only to the original purchaser, is non-transferable and applies only to "VTech" products or parts. This product is covered by a 3-month Warranty from the original purchase date, under normal use and service, against defective workmanship and materials. This Warranty does not apply to (a) consumable parts, such as batteries; (b) cosmetic damage, including but not limited to scratches and dents; (c) damage caused by use with non-VTech products; (d) damage caused by accident, misuse, unreasonable use, immersion in water, neglect, abuse, battery leakage, or improper installation, improper service, or other external causes; (e) damage caused by operating the product outside the permitted or intended uses described by VTech in the owner's manual; (f) a product or part that has been modified (g) defects caused by normal wear and tear or otherwise due to the normal aging of the product; or (h) if any VTech serial number has been removed or defaced.

Prior to returning a product for any reason, please notify the VTech Consumer Services Department, by sending an email to [vtechkids@vtechkids.com](mailto:vtechkids@vtechkids.com) or calling 1-800-521-2010. If the service representative is unable to resolve the issue, you will be provided instructions on how to return the product and have it replaced under Warranty. Return of the product under Warranty must adhere to the following rules:

If VTech believes that there may be a defect in the materials or workmanship of the product and can confirm the purchase date and location of the product, we will at our discretion replace the product with a new unit or product of comparable value. A replacement product or parts assumes the remaining Warranty of the original product or 30 days from the date of replacement, whichever provides longer coverage.

**THIS WARRANTY AND THE REMEDIES SET FORTH ABOVE ARE EXCLUSIVE AND IN LIEU OF ALL OTHER WARRANTIES, REMEDIES AND CONDITIONS, WHETHER ORAL, WRITTEN, STATUTORY, EXPRESS OR IMPLIED. IF VTECH CANNOT LAWFULLY DISCLAIM STATUTORY OR IMPLIED WARRANTIES THEN TO THE EXTENT PERMITTED BY LAW, ALL SUCH WARRANTIES SHALL BE LIMITED TO THE DURATION OF THE EXPRESS WARRANTY AND TO THE REPLACEMENT SERVICE AS DETERMINED BY VTECH IN ITS SOLE DISCRETION.**

To the extent permitted by law, VTech will not be responsible for direct, special, incidental or consequential damages resulting from any breach of Warranty.

This Warranty is not intended to persons or entities outside the United States of America. Any disputes resulting from this Warranty shall be subject to the final and conclusive determination of VTech.